

FORM B – BUILDING

Assessor's Number USGS Quad Area(s) Form Number

91/43

170

MASSACHUSETTS HISTORICAL COMMISSION
MASSACHUSETTS ARCHIVES BUILDING
220 MORRISSEY BOULEVARD
BOSTON, MASSACHUSETTS 02125

Town: Sharon

Place: (*neighborhood or village*) Sharon

Photograph



Address: 65 South Pleasant Street

Historic Name: Joseph A. Cushman

Uses: Present: Single-Family Residential

Original: Single-Family Residential

Date of Construction: c 1888

Source: Sanborn Maps and Water Records

Style/Form: Shingle

Architect/Builder:

Exterior Material:

Foundation: Cobble stone

Wall/Trim: Wood Shingles

Roof: Asphalt Shingles

Outbuildings/Secondary Structures:

A small one-story garage is located west of the residence.

Major Alterations (*with dates*):

Condition: Good

Moved: no | X | yes | | **Date** _____

Acreage 18,125 square feet

Setting: The house is set back approximately thirty feet from the road on a level lot.

Topographic or Assessor's Map

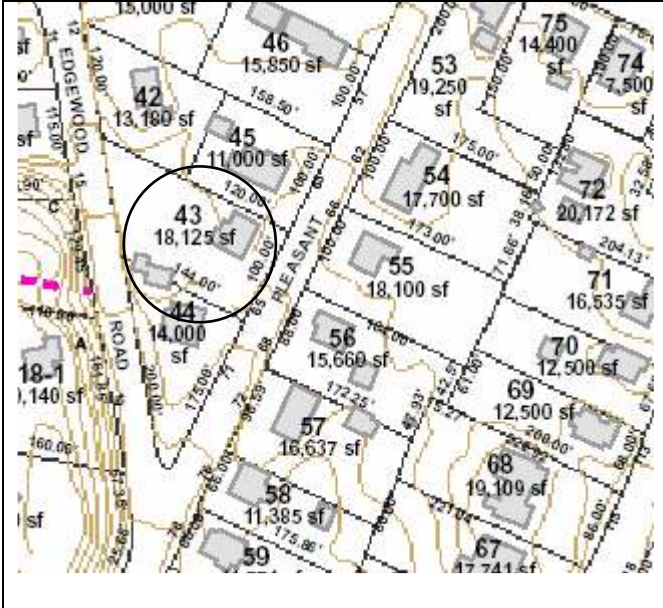

Recorded by: Julie Ann Larry & Geoffrey E. Melhuish
Turk, Tracey, and Larry Architects, LLC

Organization: Town of Sharon

Date (*month / year*): July 2008

INVENTORY FORM B CONTINUATION SHEET

SHARON

65 South Pleasant Street

MASSACHUSETTS HISTORICAL COMMISSION
220 MORRISSEY BOULEVARD, BOSTON, MASSACHUSETTS 02125

Area(s) Form No.

| |
|-----|
| 170 |
|-----|

Recommended for listing in the National Register of Historic Places.
If checked, you must attach a completed National Register Criteria Statement form.

Use as much space as necessary to complete the following entries, allowing text to flow onto additional continuation sheets.

ARCHITECTURAL DESCRIPTION:

Describe architectural features. Evaluate the characteristics of this building in terms of other buildings within the community.

65 South Pleasant Street (MHC #170) is a one-and-one-half story, wood frame Shingle-style residence. The building adopts a rectangular plan on a cobblestone foundation. The three-by-two bay building faces east and is setback approximately twenty feet from the road on a level lot. The building terminates in a gambrel roof sheathed with asphalt shingles. Two shed roof dormers are featured on the east roof plane. Each dormer features a single 1/1 double-hung wood sash window. The residence is clad with wood shingles. A one-story inset entry porch is located at the north end of the façade. Simple wood posts resting on a wood deck support the roof above. Concrete steps and a walk provide access to the porch from the driveway. A bow window is located south of the opening. A single light fixed sash window is centered in the bow. A one-story, one-car garage is located southwest of the residence. 65 South Pleasant Street is a modest Shingle-style residence that is similar to 71 South Pleasant Street.

HISTORICAL NARRATIVE

Discuss the history of the building. Explain its associations with local (or state) history. Include uses of the building, and the role(s) the owners/occupants played within the community.

While South Pleasant Street appears as early as 1876, there is little development along the street until the late nineteenth century. 65 South Pleasant Street MHC # 170 was constructed circa 1888. Sharon water records indicate that service to the property was installed in 1897. The building first appears in the 1912 book, *Sharon the Beautiful*, as the home of Joseph A. Cushman (1881-1949) curator of the Boston Society of Natural History.

Mr. Cushman is considered to be perhaps the most important foraminiferal researchers during the first half of the twentieth century. Mr. Cushman first used foraminifera to correlate sands in artesian wells for the USGS, a technique which developed into the correlation of subsurface strata in oil wells. "In 1923, he resigned from the Boston Society of Natural History and built a laboratory behind his house in Sharon, Massachusetts. From this private laboratory, Dr. Cushman consulted for oil companies, taught classes in micropaleontology to both undergraduate and graduate students, collaborated with an international array of visiting scientists, and conducted his own research with a staff of assistants (Cushman Foundation .org)" After his death in 1949, his collections and library were bequeathed to the National Museum of Natural History (Smithsonian) where they remain a major resource for researchers around the world.

In 1937, the property is the residence of Wallace Dutton, janitor at town hall, his wife, Suzanne Dutton; John C. Hall, teacher; Anna Morey; Philip Stressenger, inspector; and Walter Swanson, traffic clerk. In 1941, the Duttons and Anna Morey continue to occupy the property; the Duttons are listed as the owners. Wallace Dutton, radio police office, and Suzanne share the property in 1951 with John Hogan, post office clerk.

BIBLIOGRAPHY and/or REFERENCES

American Revolution Bicentennial Committee. *Sharon, Massachusetts: A History*. Sharon: Sharon American Revolution Bicentennial Committee, 1976.
City Directory 1923; 1937; 1942/43; 1951; 1953; 1968.
Cushman Foundation Website. Cushmanfoundation.org. 2008.
FamilySearch

INVENTORY FORM B CONTINUATION SHEET

SHARON

65 South Pleasant Street

MASSACHUSETTS HISTORICAL COMMISSION

220 MORRISSEY BOULEVARD, BOSTON, MASSACHUSETTS 02125

Area(s) Form No.

170

BIBLIOGRAPHY and/or REFERENCES continued

- Griffith, J. Eveleth. *Sharon the Beautiful: an Historical and Descriptive Sketch of Sharon, Massachusetts*. Sharon: Sharon Improvement Association, Publicity Committee, c1912.
- Map of Massachusetts, Map of Norfolk County*. E. Robinson, 1888.
- Map of Norfolk County*. Henry Francis Walling, 1853
- Map of Sharon*. Comstock & Cline, 1876.
- Map of the town of Sharon Mass*. Elijah Hewins, 1831.
- Pratt, Amy Morgan Rafter. *The History of Sharon Massachusetts to 1865*. [S.I]: Privately published by Frieda Billings Cushman, 1966 Door's Print Shop.
- Sharon Historical Society. *Scrapbook: Sharon Historical Society, Sharon, Massachusetts*. Sharon Historical Society 1904-1908.
- Sanborn Fire Insurance Maps*. March 1916; April 1924; February 1944; 1953.
- U.S. Commerce Dept. Census Bureau, 1840-1930.
- Water Records of Sharon.

